

# Control Station and Control Panel: Panel Mounted Operating Devices and Windows, IIB



## Flameproof and Dust protection by enclosure

Zone 1 & 2 – 21 & 22

### Application

The panel mounted operating devices are designed for used with the flameproof enclosure and dust protection enclosure for controlling or indicating the status of electrical equipment such as motor starter, control equipment operation. They are suitable for Zone 1, 2 and Zone 21, 22 hazardous areas.

### Specification

Thread coupling, Shaft	: Stainless steel
Thread bushing	: Aluminium
Lock nut	: Nickel-plated brass
Flush button	: Plastic
O-ring	: Neoprene

### Technical Data

<b>Hazardous Area</b>	Gas	Dust
<b>Zones</b>	1 & 2	21 & 22
<b>Equipment Group/Category</b>	Ex II 2G	Ex II 2D
<b>Symbol of Protection</b>	Ex db IIB	Ex tb IIIB IP66
<b>Ambient Temperature</b>	-20°C to +60°C	
<b>Index of Protection</b>	IP66	
<b>Certificate</b>	Presafe 16 ATEX 8037 U IECEx PRE 16.0026 U	
<b>Conformity to Standards</b>	EN 60079-0:2012+A11:2013, EN 60079-1:2007, EN 60079-31:2014 IEC 60079-0:2011, IEC 60079-1:2007-04, IEC 60079-31:2008	

D

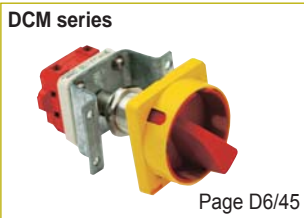
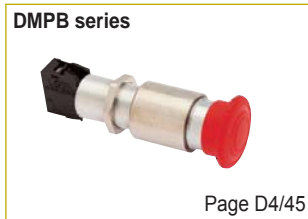

### Electrical Rating

**Pilot lights characteristics**

Current consumption	For all colours	24V.dc/ ac	20mA. (27 max)
		120V.ac	18mA. (21 max)
		230-240V.ac	16mA. (20 max)
Voltage limit	At nominal voltage	24V.dc	19.2-30V.dc
		24V.ac	26.1-26.4V.ac
		120V.ac	100-132V.ac
Service life	At nominal voltage and at an ambient temp. of 25°C	230-240V.ac	195-264V.ac
			70,000Hrs.

**Contact Block ratings**

Rated operational current (EN/IEC 60947-5-1)	AC15	240V.	3A.
		600V.	1.2A.
	DC13	250V.	0.27A.
600V.		0.1A.	
Rated thermal current			10A.
Rated insulation voltage			600V.

**Cam operated switches**

Rated operational current (EN/IEC 60947-3)	16A.	25A.	32A.
	20A.	30A.	40A.
	Rated insulation voltage	400V.	400V.

# Control Station and Control Panel: Panel Mounted Operating Devices and Windows, IIB

Flameproof and Dust protection by enclosure

Zone 1 & 2 – 21 & 22



## Pilot Light, DPL series



Dimension in mm. (L)

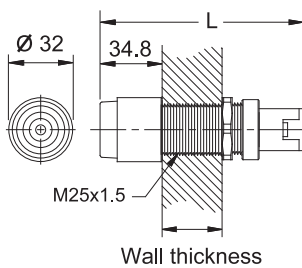

Wall thickness of enclosure (□)	
A (15-30mm.)	B (31-45mm.)
99.0	119.0

## Catalogue Number Logic

<b>DPL</b> -	□	■ ■ ■	■
Series	Wall thickness of enclosure	Voltage	Colour of lens
A	15-30 mm.	D02 24V.dc	G Green B Blue
B	31-45 mm.	A12 120V.ac	R Red C Clear
		A22 220-230V.ac	Y Yellow

## Ordering Requirements

Operating Voltage	Diagram (Integral LED)	Colour of Lens	Cat. No.	Approx. Weight (kgs.)
24V.dc/ ac ~		Green	DPL-□ D02G	0.145
		Red	DPL-□ D02R	
		Yellow	DPL-□ D02Y	
		Blue	DPL-□ D02B	
		Clear	DPL-□ D02C	
120V.ac ~		Green	DPL-□ A12G	0.145
		Red	DPL-□ A12R	
		Yellow	DPL-□ A12Y	
		Blue	DPL-□ A12B	
		Clear	DPL-□ A12C	
220-230V.ac 50/60Hz. ~		Green	DPL-□ A22G	0.145
		Red	DPL-□ A22R	
		Yellow	DPL-□ A22Y	
		Blue	DPL-□ A22B	
		Clear	DPL-□ A22C	

## Push Button, DPB series



Dimension in mm. (L)

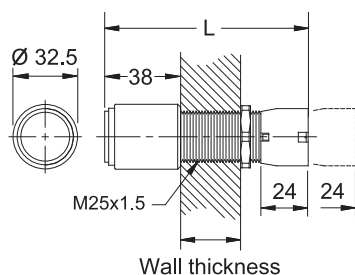

Wall thickness of enclosure (□)	
A (15-30mm.)	B (31-45mm.)
96.0	116.0

## Catalogue Number Logic

<b>DPB</b> -	□	■ ■	■
Series	Wall thickness of enclosure	Contact	Colour of button
A	15-30 mm.	10 1NO 20 2NO	G Green B Black
B	31-45 mm.	01 1NC 02 2NC	R Red W White
		11 1NO-1NC	Y Yellow

## Ordering Requirements

Type of Function	Contact Symbol	Colour of Button	Cat. No.	Approx. Weight (kgs.)
Momentary		Green	DPB-□ 10G	0.215
		Red	DPB-□ 10R	
		Yellow	DPB-□ 10Y	
		Black	DPB-□ 10B	
		White	DPB-□ 10W	
		Green	DPB-□ 01G	0.215
		Red	DPB-□ 01R	
		Yellow	DPB-□ 01Y	
		Black	DPB-□ 01B	
		White	DPB-□ 01W	
		Green	DPB-□ 11G	0.230
		Red	DPB-□ 11R	
		Yellow	DPB-□ 11Y	
		Black	DPB-□ 11B	
		White	DPB-□ 11W	
		Green	DPB-□ 20G	0.230
		Red	DPB-□ 20R	
		Yellow	DPB-□ 20Y	
		Black	DPB-□ 20B	
		White	DPB-□ 20W	
		Green	DPB-□ 02G	0.230
		Red	DPB-□ 02R	
		Yellow	DPB-□ 02Y	
		Black	DPB-□ 02B	
		White	DPB-□ 02W	

# Control Station and Control Panel: Panel Mounted Operating Devices and Windows, IIB



Flameproof and Dust protection by enclosure  
Zone 1 & 2 – 21 & 22

## Push Button Shaft, DPBS series



Dimension in mm. (L)

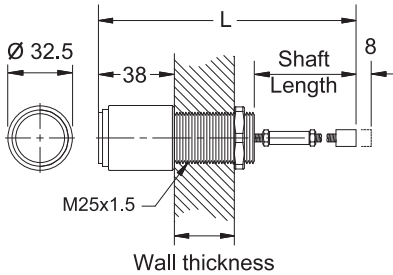

Wall thickness of enclosure (□)			
50mm. shaft length		100mm. shaft length	
A (15-30mm.)	B (31-45mm.)	A (15-30mm.)	B (31-45mm.)
122.0	142.0	172.0	192.0

## Catalogue Number Logic

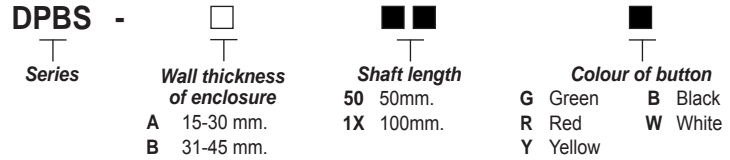

## Ordering Requirements

Type of Function	Shaft Length	Colour of Button	Cat. No.	Approx. Weight (kgs.)
Momentary	50mm.	Green	DPBS-□ 50G	0.215
		Red	DPBS-□ 50R	
		Yellow	DPBS-□ 50Y	
		Black	DPBS-□ 50B	
		White	DPBS-□ 50W	
	100mm.	Green	DPBS-□ 1XG	0.235
		Red	DPBS-□ 1XR	
		Yellow	DPBS-□ 1XY	
		Black	DPBS-□ 1XB	
		White	DPBS-□ 1XW	

## Mushroom-Head Push Button, DMPB series



Dimension in mm. (L)

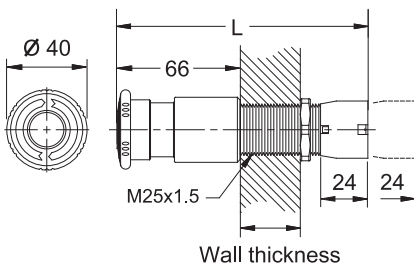

### Push-pull

Wall thickness of enclosure (□)	
A (15-30mm.)	B (31-45mm.)
125.0	145.0

### Push-lock, Turn to release

Wall thickness of enclosure (□)	
A (15-30mm.)	B (31-45mm.)
122.5	142.5

## Catalogue Number Logic

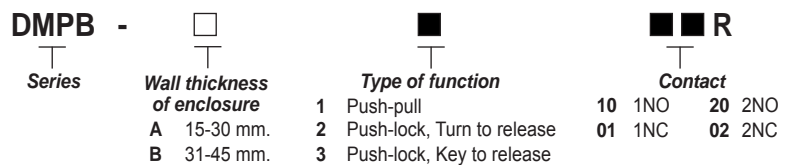

## Ordering Requirements

Type of Function	Contact	Colour of Button	Cat. No.	Approx. Weight (kgs.)
Push-pull	1NO	Red	DMPB-□ 110R	0.254
Push-lock, Turn to release			DMPB-□ 210R	0.254
Push-lock, Key to release			DMPB-□ 310R	0.255
Push-pull	1NC	Red	DMPB-□ 101R	0.254
Push-lock, Turn to release			DMPB-□ 201R	0.254
Push-lock, Key to release			DMPB-□ 301R	0.255
Push-pull	2NO	Red	DMPB-□ 120R	0.269
Push-lock, Turn to release			DMPB-□ 220R	0.269
Push-lock, Key to release			DMPB-□ 320R	0.270
Push-pull	2NC	Red	DMPB-□ 102R	0.269
Push-lock, Turn to release			DMPB-□ 202R	0.269
Push-lock, Key to release			DMPB-□ 302R	0.270

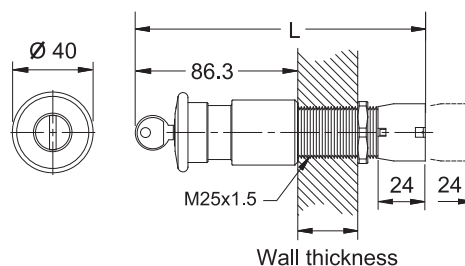

### Push-lock, Key to release

Wall thickness of enclosure (□)	
A (15-30mm.)	B (31-45mm.)
145.5	165.5

# Control Station and Control Panel: Panel Mounted Operating Devices and Windows, IIB

Flameproof and Dust protection by enclosure

Zone 1 & 2 – 21 & 22



## Catalogue Number Logic

<b>D</b> ■ ■	-	□	■	■ ■	■
<b>Series</b>		<b>Wall thickness of enclosure</b>	<b>Position</b>	<b>Contact</b>	<b>Function</b>
<b>DSL</b> Selector Switch		<b>A</b> 15-30 mm.	<b>2</b> 2-Positions	<b>10</b> 1NO <b>20</b> 2NO	<b>S</b> Spring return
<b>DSLK</b> Key Selector Switch		<b>B</b> 31-45 mm.	<b>3</b> 3-Positions	<b>01</b> 1NC <b>02</b> 2NC	<b>R</b> Spring return from Right
				<b>11</b> 1NO-1NC	

## Selector Switch, DSL series



Dimension in mm. (L)

2-Positions

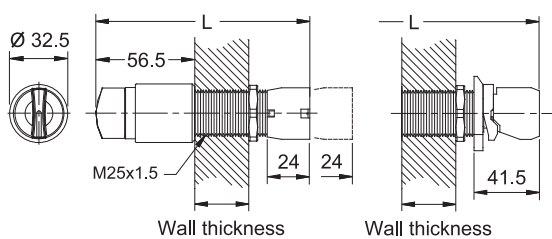

Wall thickness of enclosure (□)			
2-Positions		3-Positions	
A (15-30mm.)	B (31-45mm.)	A (15-30mm.)	B (31-45mm.)
115.5	165.5	132.0	152.0

## Ordering Requirements

Type of Function	Contact	Cat. No.	Approx. Weight (kgs.)
<b>2-Positions</b>			
Stay put (or Maintained)	1NO	DSL- □ 210	0.230
	2NO	DSL- □ 220	0.245
	1NO-1NC	DSL- □ 211	0.245
Spring return	1NO	DSL- □ 210S	0.230
	2NO	DSL- □ 220S	0.245
	1NO-1NC	DSL- □ 211S	0.245
<b>3-Positions</b>			
Stay put (or Maintained)	2NO	DSL- □ 320	0.250
Spring return from right to centre	2NO	DSL- □ 320R	0.250

## Key Selector Switch, DSLK series



Dimension in mm. (L)

2-Positions

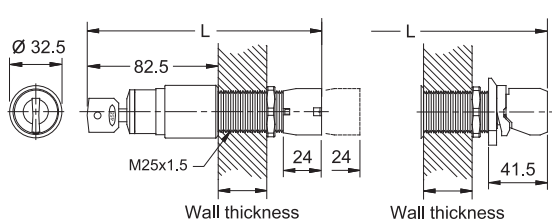

Wall thickness of enclosure (□)			
2-Positions		3-Positions	
A (15-30mm.)	B (31-45mm.)	A (15-30mm.)	B (31-45mm.)
141.5	161.5	158.0	178.0

## Ordering Requirements

Type of Function	Contact	Cat. No.	Approx. Weight (kgs.)
<b>2-Positions</b>			
Stay put (or Maintained)	1NO	DSLK- □ 210	0.235
	2NO	DSLK- □ 220	0.250
	1NO-1NC	DSLK- □ 211	0.250
<b>3-Positions</b>			
Stay put (or Maintained)	2NO	DSLK- □ 320	0.255

# Control Station and Control Panel: Panel Mounted Operating Devices and Windows, IIB



Flameproof and Dust protection by enclosure  
Zone 1 & 2 – 21 & 22

## Cam Operated Switch, DCM series

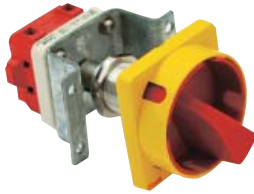

## Catalogue Number Logic

<b>DCM</b>	-	□	■	■ ■
Series	Wall thickness of enclosure	Type of function	Ampere	
	A 15-30 mm. B 31-45 mm.	1 Single pole 2 Double poles	16 16A. 25 25A. 32 32A.	

Dimension in mm. (L)

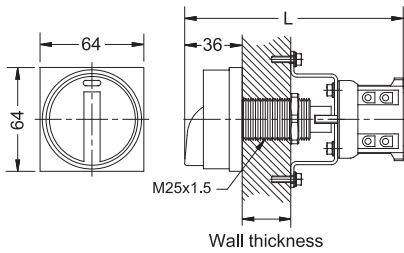

Wall thickness of enclosure (□)	
A (15-30mm.)	B (31-45mm.)
128.0	148.0

## Ordering Requirements

Ampere	Connection	Cat. No.	Approx. Weight (kgs.)	
<b>2-Steps (Position 45°)</b>				
Single pole	16A.		0.318	
	25A.			DCM-□ 125
	32A.			DCM-□ 132
Double poles	16A.		0.350	
	25A.			DCM-□ 225
	32A.			DCM-□ 232

## Inspection Window (Round type)

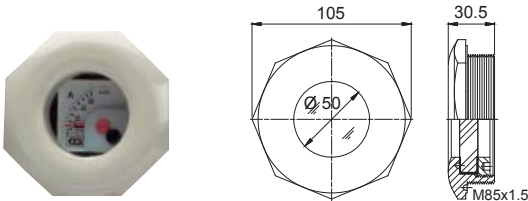

## Ordering Requirements

Lens diameter * (mm.)	Cat. No.	Wall thickness	Approx. Weight (kgs.)
50	LCGR-50-M85	10-45mm.	0.515

\* Suitable for meters with maximum panel size of 48x48mm.

# Control Station and Control Panel: Panel Mounted Operating Devices and Windows, IIC



## Flameproof and Dust protection by enclosure

Zone 1 & 2 – 21 & 22

### Application

The panel mounted operating devices are designed for used with the flameproof enclosure and dust protection enclosure for controlling or indicating the status of electrical equipment such as motor starter, control equipment operation. They are suitable for Zone 1, 2 and Zone 21, 22 hazardous areas.

### Technical Data

<b>Hazardous Area</b>		Gas	Dust
<b>Zones</b>		1 & 2	21 & 22
<b>Equipment Group/Category</b>		Ⓔ II 2G	Ⓔ II 2D
<b>Symbol of Protection</b>	DPL1, DPB1, DPBS1, DMPB1, ASPB1, DSL1 & DSLK1 series	Ex db IIC Gb	Ex tb IIIC Db IP66
	ACM1, ACM2, ALCB1, ALCB2, & ALCB3 series		Ex tb IIIC Db IP65
	DCM1 series		Ex tb IIIC Db IP66
	LGCR, LGCR1 & LGCS series	Ex db IIB+H2 Gb	Ex tb IIIC Db IP66
<b>Certificate</b>	TÜV CY 17 ATEX 0205880 U		
<b>Conformity to Standards</b>	EN 60079-0:2012+A11:2013, EN 60079-1:2014, EN 60079-31:2014		
<b>Ambient Temperature</b>	-20°C to +55°C	<b>Index of Protection</b>	IP65/ IP66

### Specification

Thread coupling, Shaft :  
Stainless steel  
Thread bushing : Aluminium  
Lock nut : Nickel-plated  
brass  
Flush button : Plastic  
O-ring : Neoprene

### Electrical Rating

Pilot lights characteristics				
Current consumption	For all colours	24V.dc/ ac	20mA. (27 max)	
		120V.ac	18mA. (21 max)	
		230-240V.ac	16mA. (20 max)	
Voltage limit	At nominal voltage	24V.dc	19.2-30V.dc	
		24V.ac	26.1-26.4V.ac	
		120V.ac	100-132V.ac	
		230-240V.ac	195-264V.ac	
Service life	At nominal voltage and at an ambient temp. of 25°C	70,000Hrs.		

### Contact Block ratings

Rated operational current (EN/IEC 60947-5-1)	AC15 240V.	3A.
	600V.	1.2A.
Rated thermal current	DC13 250V.	0.27A.
	600V.	0.1A.
Rated thermal current	10A.	
Rated insulation voltage	600V.	

### Cam operated switches

Rated operational current (EN/IEC 60947-3)	16A.	25A.	32A.
	20A.	30A.	40A.
	400V.	400V.	600V.

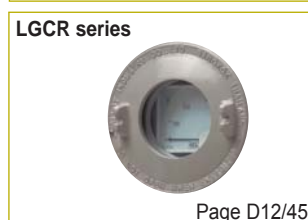
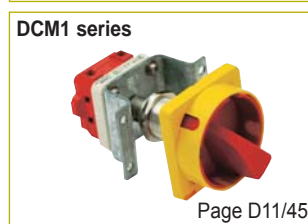
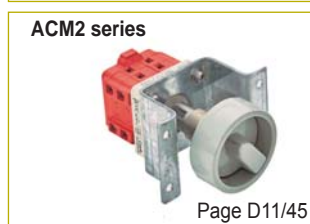
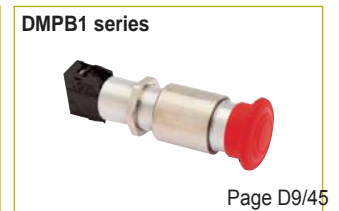
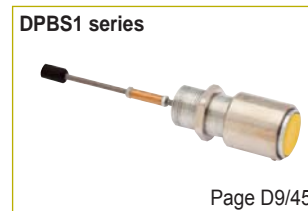

# Control Station and Control Panel: Panel Mounted Operating Devices and Windows, IIC



Flameproof and Dust protection by enclosure  
Zone 1 & 2 – 21 & 22

## Pilot Light, DPL1 series



Dimension in mm. (L)

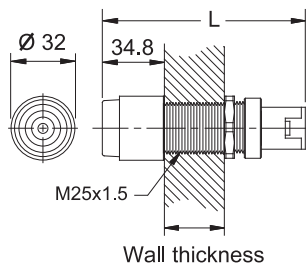

Wall thickness of enclosure (□)	
A (15-30mm.)	B (31-45mm.)
99.0	119.0

## Catalogue Number Logic

<b>DPL1</b> -	□	■ ■ ■	■
Series	Wall thickness of enclosure	Voltage	Colour of lens
	A 15-30 mm. B 31-45 mm.	D02 24V.dc A12 120V.ac A22 220-230V.ac	G Green R Red Y Yellow B Blue C Clear

## Ordering Requirements

Operating Voltage	Diagram (Integral LED)	Colour of Lens	Cat. No.	Approx. Weight (kgs.)
24V.dc/ ac ~	X1 ⊗ X2	Green	DPL1-□ D02G	0.145
		Red	DPL1-□ D02R	
		Yellow	DPL1-□ D02Y	
		Blue	DPL1-□ D02B	
		Clear	DPL1-□ D02C	
120V.ac ~	X1 ⊗ X2	Green	DPL1-□ A12G	0.145
		Red	DPL1-□ A12R	
		Yellow	DPL1-□ A12Y	
		Blue	DPL1-□ A12B	
		Clear	DPL1-□ A12C	
220-230V.ac 50/60Hz. ~	X1 ⊗ X2	Green	DPL1-□ A22G	0.145
		Red	DPL1-□ A22R	
		Yellow	DPL1-□ A22Y	
		Blue	DPL1-□ A22B	
		Clear	DPL1-□ A22C	

## Push Button, DPB1 series



Dimension in mm. (L)

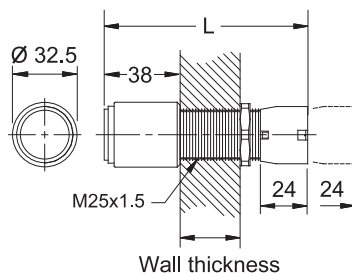

Wall thickness of enclosure (□)	
A (15-30mm.)	B (31-45mm.)
96.0	116.0

## Catalogue Number Logic

<b>DPB1</b> -	□	■ ■	■
Series	Wall thickness of enclosure	Contact	Colour of button
	A 15-30 mm. B 31-45 mm.	10 1NO    20 2NO 01 1NC    02 2NC 11 1NO-1NC	G Green    B Black R Red     W White Y Yellow

## Ordering Requirements

Type of Function	Contact Symbol	Colour of Button	Cat. No.	Approx. Weight (kgs.)
Momentary	E ⊗	Green	DPB1-□ 10G	0.215
		Red	DPB1-□ 10R	
		Yellow	DPB1-□ 10Y	
		Black	DPB1-□ 10B	
		White	DPB1-□ 10W	
	E ⊗	Green	DPB1-□ 01G	0.215
		Red	DPB1-□ 01R	
		Yellow	DPB1-□ 01Y	
		Black	DPB1-□ 01B	
		White	DPB1-□ 01W	
	E ⊗	Green	DPB1-□ 11G	0.230
		Red	DPB1-□ 11R	
		Yellow	DPB1-□ 11Y	
		Black	DPB1-□ 11B	
		White	DPB1-□ 11W	
	E ⊗	Green	DPB1-□ 20G	0.230
		Red	DPB1-□ 20R	
		Yellow	DPB1-□ 20Y	
		Black	DPB1-□ 20B	
		White	DPB1-□ 20W	
	E ⊗	Green	DPB1-□ 02G	0.230
		Red	DPB1-□ 02R	
		Yellow	DPB1-□ 02Y	
		Black	DPB1-□ 02B	
		White	DPB1-□ 02W	

# Control Station and Control Panel: Panel Mounted Operating Devices and Windows, IIC

Flameproof and Dust protection by enclosure

Zone 1 & 2 – 21 & 22



## Push Button Shaft, DPBS series



Dimension in mm. (L)

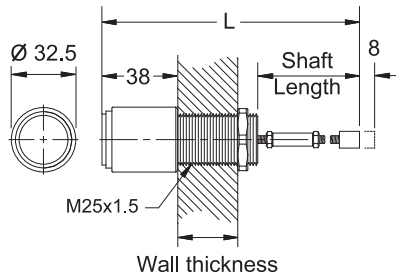

Wall thickness of enclosure (□)			
50mm. shaft length		100mm. shaft length	
A (15-30mm.)	B (31-45mm.)	A (15-30mm.)	B (31-45mm.)
122.0	142.0	172.0	192.0

## Catalogue Number Logic

<b>DPBS1</b> -	□	■ ■	■
Series	Wall thickness of enclosure	Shaft length	Colour of button
	A 15-30 mm. B 31-45 mm.	50 50mm. 1X 100mm.	G Green B Black R Red W White Y Yellow

## Ordering Requirements

Type of Function	Shaft Length	Colour of Button	Cat. No.	Approx. Weight (kgs.)
Momentary	50mm.	Green	DPBS1-□ 50G	0.215
		Red	DPBS1-□ 50R	
		Yellow	DPBS1-□ 50Y	
		Black	DPBS1-□ 50B	
		White	DPBS1-□ 50W	
	100mm.	Green	DPBS1-□ 1XG	0.235
		Red	DPBS1-□ 1XR	
		Yellow	DPBS1-□ 1XY	
		Black	DPBS1-□ 1XB	
		White	DPBS1-□ 1XW	

## Mushroom-Head Push Button, DMPB1 series



Dimension in mm. (L)

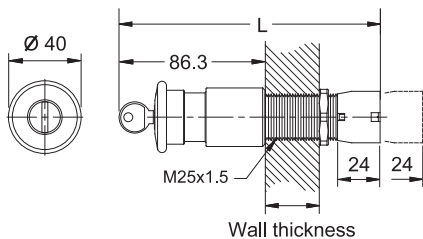

Wall thickness of enclosure (□)	
Push-Lock, Key to release	
A (15-30mm.)	B (31-45mm.)
145.5	165.5

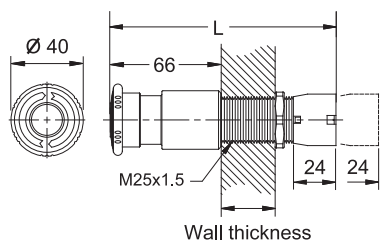

## Catalogue Number Logic

<b>DMPB1</b> -	□	■	■ ■ R
Series	Wall thickness of enclosure	Type of function	Contact
	A 15-30 mm. B 31-45 mm.	1 Push-pull 2 Push-lock, Turn to release 3 Push-lock, Key to release	10 1NO 20 2NO 01 1NC 02 2NC

## Ordering Requirements

Type of Function	Contact	Colour of Button	Cat. No.	Approx. Weight (kgs.)
Push-pull	1NO	Red	DMPB1-□ 110R	0.254
Push-lock, Turn to release			DMPB1-□ 210R	0.254
Push-lock, Key to release			DMPB1-□ 310R	0.255
Push-pull	1NC	Red	DMPB1-□ 101R	0.254
Push-lock, Turn to release			DMPB1-□ 201R	0.254
Push-lock, Key to release			DMPB1-□ 301R	0.255
Push-pull	2NO	Red	DMPB1-□ 120R	0.269
Push-lock, Turn to release			DMPB1-□ 220R	0.269
Push-lock, Key to release			DMPB1-□ 320R	0.270
Push-pull	2NC	Red	DMPB1-□ 102R	0.269
Push-lock, Turn to release			DMPB1-□ 202R	0.269
Push-lock, Key to release			DMPB1-□ 302R	0.270

Wall thickness of enclosure (□)			
Push-pull		Push-Lock, Turn to release	
A (15-30mm.)	B (31-45mm.)	A (15-30mm.)	B (31-45mm.)
125.0	145.0	122.5	142.5

## Special Purpose Push Button Shaft, ASPB1 series

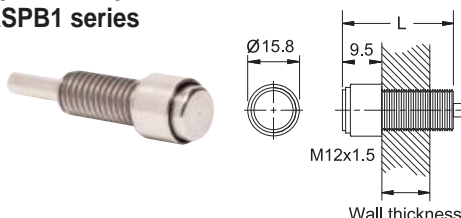

Dimension in mm. (L)

Wall thickness of enclosure (□)		Type of Function	Wall Thickness	Colour of Button	Cat. No.
A (15-20mm.)	B (21-45mm.)	Momentary	15-20mm.	Stainless (natural)	ASPB1-A ASPB1-B
36.5	29.5		21-45mm.		



# Control Station and Control Panel: Panel Mounted Operating Devices and Windows, IIC



Flameproof and Dust protection by enclosure  
Zone 1 & 2 – 21 & 22

## Catalogue Number Logic

<b>D</b> ■ ■ ■ 1	-	□	■	■ ■	■
<b>Series</b>		<b>Wall thickness of enclosure</b>	<b>Position</b>	<b>Contact</b>	<b>Function</b>
DSL1 Selector Switch		A 15-30 mm.	2 2-Positions	10 1NO 20 2NO	S Spring return
DSLK1 Key Selector Switch		B 31-45 mm.	3 3-Positions	01 1NC 02 2NC	R Spring return from Right
				11 1NO-1NC	

## Selector Switch, DSL1 series



Dimension in mm. (L)

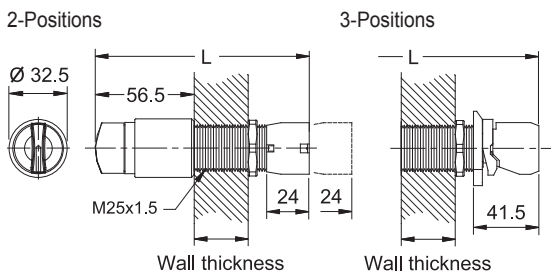

Wall thickness of enclosure (□)			
2-Positions		3-Positions	
A (15-30mm.)	B (31-45mm.)	A (15-30mm.)	B (31-45mm.)
115.5	165.5	132.0	152.0

## Ordering Requirements

Type of Function	Contact	Cat. No.	Approx. Weight (kgs.)
<b>2-Positions</b>			
Stay put (or Maintained)	1NO	DSL1-□ 210	0.230
	2NO	DSL1-□ 220	0.245
	1NO-1NC	DSL1-□ 211	0.245
Spring return	1NO	DSL1-□ 210S	0.230
	2NO	DSL1-□ 220S	0.245
	1NO-1NC	DSL1-□ 211S	0.245
<b>3-Positions</b>			
Stay put (or Maintained)	2NO	DSL1-□ 320	0.250
Spring return from right to centre	2NO	DSL1-□ 320R	0.250

## Key Selector Switch, DSLK1 series



Dimension in mm. (L)

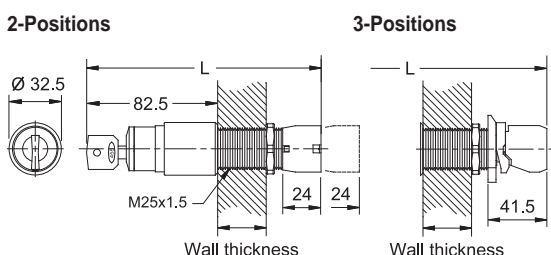

## Ordering Requirements

Type of Function	Contact	Cat. No.	Approx. Weight (kgs.)
<b>2-Positions</b>			
Stay put (or Maintained)	1NO	DSLK1-□ 210	0.235
	2NO	DSLK1-□ 220	0.250
	1NO-1NC	DSLK1-□ 211	0.250
<b>3-Positions</b>			
Stay put (or Maintained)	2NO	DSLK1-□ 320	0.255

Wall thickness of enclosure (□)			
2-Positions		3-Positions	
A (15-30mm.)	B (31-45mm.)	A (15-30mm.)	B (31-45mm.)
141.5	161.5	158.0	178.0

# Control Station and Control Panel: Panel Mounted Operating Devices and Windows, IIC



Flameproof and Dust protection by enclosure

Zone 1 & 2 – 21 & 22

## Catalogue Number Logic

■ ■ ■ 1	-	□	■	■ ■	<b>Cam Operated Switch Type-1, DCM1 series</b>
Series		Wall thickness of enclosure (see dimension table)	Type of function	Ampere	
DCM1	Cam operated switch type-1		1 Single pole	16 16A.	
ACM1	Cam operated switch type-2		2 Double poles	25 25A. 32 32A.	

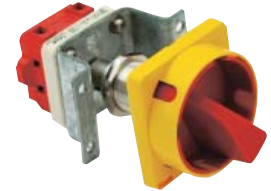

Dimension in mm. (L)

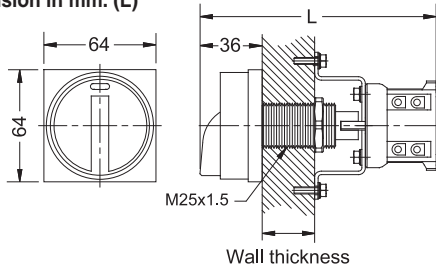

Wall thickness of enclosure (□)	
A (15-30mm.)	B (31-45mm.)
128.0	148.0

## Ordering Requirements

Ampere	Connection	Cat. No.	Approx. Weight (kgs.)	
<b>2-Steps (Position 45°)</b>				
Single pole	16A.	DCM1-□ 116	0.318	
	25A.			DCM1-□ 125
	32A.			DCM1-□ 132
Double poles	16A.	DCM1-□ 216	0.350	
	25A.			DCM1-□ 225
	32A.			DCM1-□ 232

## Cam Operated Switch Type-2, ACM1 series



Dimension in mm. (L)

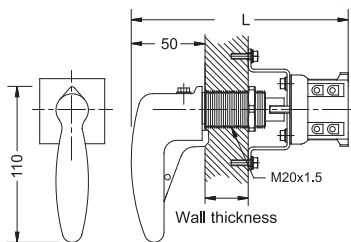

## Ordering Requirements

Ampere	Connection	Cat. No.	Approx. Weight (kgs.)	
<b>2-Steps (Position 45°)</b>				
Single pole	16A.	ACM1-□ 116	0.24	
	25A.			ACM1-□ 125
	32A.			ACM1-□ 132
Double poles	16A.	ACM1-□ 216	0.30	
	25A.			ACM1-□ 225
	32A.			ACM1-□ 232

Wall thickness of enclosure (□)	
A (15-20mm.)	B (21-45mm.)
138.0	161.0

## Cam Operated Switch Type-3, ACM2 series



Dimension in mm. (L)

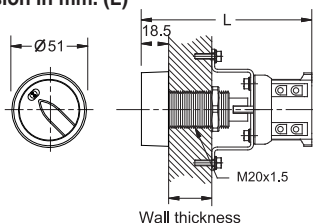

## Ordering Requirements

Ampere	Connection	Cat. No.	Approx. Weight (kgs.)	
<b>2-Steps (Position 45°)</b>				
Single pole	16A.	ACM2-□ 116	0.24	
	25A.			ACM2-□ 125
	32A.			ACM2-□ 132
Double poles	16A.	ACM2-□ 216	0.30	
	25A.			ACM2-□ 225
	32A.			ACM2-□ 232

Wall thickness of enclosure (□)	
A (15-20mm.)	B (21-45mm.)
138.0	161.0

# Control Station and Control Panel: Panel Mounted Operating Devices and Windows, IIC

Flameproof and Dust protection by enclosure  
Zone 1 & 2 – 21 & 22

## Ordering Requirements

### Mechanism for Circuit Breaker

**Mechanism No.1**  
for Miniature Circuit Breaker (63AF/ 125AF), ALCB1 series

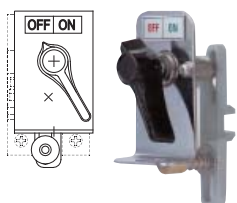

**Slide Plate (Left)**

Wall thickness	Cat. No.
15-20mm.	ALCB1L-A
21-45mm.	ALCB1L-B

**Slide Plate (Right)**

Wall thickness	Cat. No.
15-20mm.	ALCB1R-A
21-45mm.	ALCB1R-B

Approx. weight; 0.189 kgs.

**Mechanism No.3**  
for Molded-Case Circuit Breaker (400 to 800AF), ALCB3 series

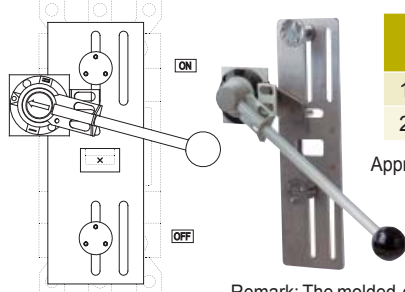

Wall thickness	Cat. No.
15-20mm.	ALCB3-A
21-45mm.	ALCB3-B

Approx. weight; 2.707 kgs.

Remark: The molded-case circuit breaker ALCB series is limited for installation on enclosures with internal free volume  $\leq 2000\text{cm}^3$ .

**Mechanism No.2 for Molded-Case Circuit Breaker (30 to 250AF), ALCB2 series**

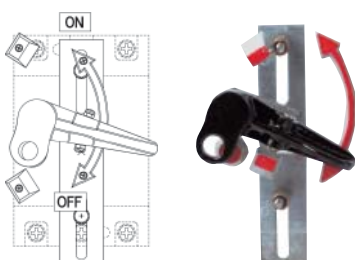

**Handle Type-1**

Wall thickness	Cat. No.
15-20mm.	ALCB21-A
21-45mm.	ALCB21-B

**Handle Type-2**

Wall thickness	Cat. No.
15-20mm.	ALCB22-A
21-45mm.	ALCB22-B

Approx. weight; 0.425 kgs.

**Inspection Window (Round type),  
LGCR/ LGCR1 series**

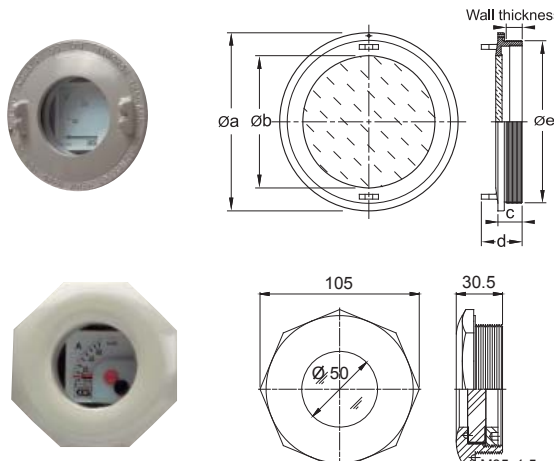

Technical drawing showing dimensions:  $\phi a$ ,  $\phi b$ ,  $\phi e$ ,  $c$ ,  $d$ , and Wall thickness.

## Ordering Requirements

Lens diameter * $\phi b$ (mm.)	Cat. No.	Dimension in mm.				Wall thickness	Approx. Weight (kgs.)
		$\phi a$	c	d	$\phi e$		
117	LGCR-113	189			M164	15-45mm.	1.52
179	LGCR-217	251	46	61	M226	15-45mm.	2.41
208	LGCR-320	280			M255	15-45mm.	2.89

\* Suitable for meters with maximum panel size of 96x96mm. or 72x72mm. respectively.

Lens diameter * (mm.)	Cat. No.	Wall thickness	Approx. Weight (kgs.)
50	LGCR1-50-M85	10-45mm.	0.515

\* Suitable for meters with maximum panel size of 48x48mm.

**Inspection Window (Rectangular type),  
LGCS series**

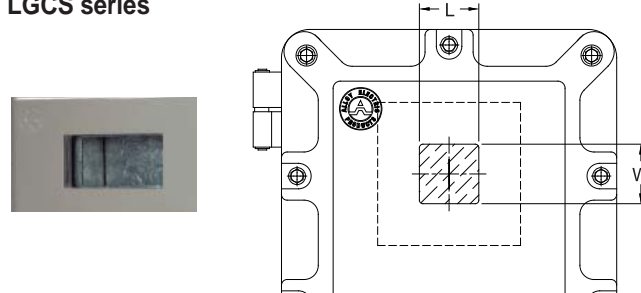

Technical drawing showing dimensions: L, W, and Wall thickness.

## Ordering Requirements

Cat. No.	Dimension in mm.		Wall thickness
	W	L	
LGCS-142	42	42	15-45mm.
LGCS-260	60	60	15-45mm.
LGCS-383	83	83	15-45mm.
LGCS-430	30	145	15-45mm.
LGCS-5120	120	120	15-45mm.
LGCS-6200	200	200	15-45mm.